

SW305K5

PRODUCT SPECIFICATIONS

SANY



STANDARD FEATURES

- Engine: Deutz TCD 6.1 (EU Stage 5)
- Boom Suspension System
- Locking Differential Axle
- Automatic Transmission Kick Down
- Bucket Self-Leveling and Return to Dig
- SANYLive Telematics
- Single Joystick Control
- Third Function Hydraulics
- Reversible fan
- 360° View Camera

Gross Power
129 kW

Bucket Capacity
2.3 m³

Operating Weight
14 500 kg

Full Turn Tipping Load
7 714 kg

PRODUCT SPECIFICATIONS

SANY SW305K5

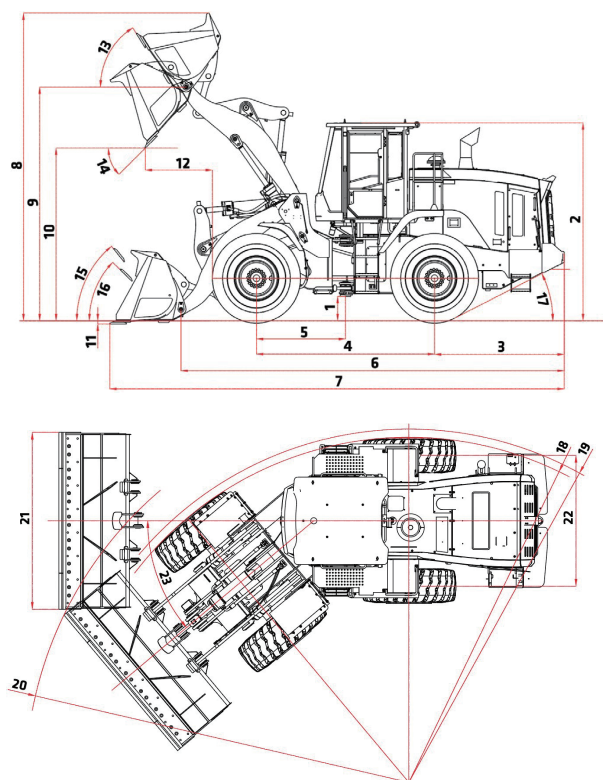

OVERALL DIMENSIONS

	STANDARD
1 Ground Clearance	407 mm
2 Height to Top of Cab	3 405 mm
3 Center Line of Rear Axle to Edge of Counterweight	1 911 mm
4 Wheelbase	3 000 mm
5 Center Line of Front Axle to Center Pivot	1 480 mm
6 Shipping Length without Attachment	6 226 mm
7 Shipping Length with Bucket	7 518 mm
8 Max. Dump Height	5 226 mm
9 Hinge Pin Height at Max. Lift	3 845 mm
10 Dump Clearance at Max. Lift	2 689 mm
11 Dig Depth, Level Bucket	122 mm
12 Reach at Max. Lift and 45° Discharge	1 038 mm
13 Roll Back at Max. Lift	61°
14 Dump Angle at Max. Lift and Dump	45°
15 Roll Back at Carry Height	49°
16 Roll Back at Ground	42°
17 Tail Angle to the Rear Wheel	28°
18 Clearance Circle to Outside of Tires	5 382 mm
19 Clearance Circle to Counterweight	5 365 mm
20 Max. Circle	5 969 mm
21 Width of the Bucket	2 545 mm
22 Width	2 045 mm
23 Articulation Angle	+/- 40°

In the interest of continual equipment development, SANY reserves the right to change these specifications at any time without prior notification.

Machine Parameters

WEIGHT

Operating Weight	14 500 kg
------------------	-----------

ENGINE

Deutz TCD6.1

Max Gross Power	129 kW
Net Engine Power	116 kW
Max Gross Torque	750 Nm
Displacement	6.1 L

OPERATING

Bucket Capacity	2.3 m³
Breakout Force	123 kN
Tipping Load Straight	8 899 kg
Tipping Load @ Full Turn	7 714 kg
Clearance (full lift 45° dump)	2 689 mm
Reach (full lift 45° dump)	1 038 mm

HYDRAULIC SYSTEM

Max Flow	220 LPM
Max Pressure	27 MPa

HYDRAULIC CYCLE TIMES

Raise	5.6 sec
Dump	1.6 sec
Float Down	3.2 sec
Total Cycle Time	10.4 sec

SERVICE CAPACITIES

Fuel Tank	227 L
Cooling System	33 L
Engine Crankcase	15.5 L
Transmission	55 L
Front Axle	34.8 L
Rear Axle	34.8 L
Hydraulic Tank	128.7 L
DEF Tank	10 L

TRANSMISSION

Shift Modes	Automatic, Manual, Kick Down
Forward Gear 1-4	7/14/27/41 km/h
Reverse Gear 1-3	7/14/27 km/h

POWER TRAIN

Front Axle	Fixed
Traction Aid	Manual Differential Lock
Rear Axle	Oscillating
Traction Aid	Open Differential
Service Brake	Wet Disk
Parking Brake	Disk Brake

SANY

PRODUCT EQUIPMENT

Standard ● Optional ○

ENGINE

Exhaust aftertreatment (DPF+SCR)	●
Keyless start	●
Engine emergency stop (in cab)	●
P/E Patten	●
Cold start aid (air pre-heated)	●
Hydraulic-driven fan, regulated by temperature (Reversible rotation, auto)	●

POWER TRAIN

Gear selector lever (Steering-column)	●
Fully automatic shifting 1-4, H/L Patten & Manual	●
Automatic Transmission Kick Down	●
Clutch-cutoff	●
Service brake, 4-wheel, wet-type, hydraulic brake	●
Parking brake, Electronically controlled, hydraulic caliper disc brake	●
Differential lock front axle (manual)	●

HYDRAULIC

Full variable load-sensing system with steering priority	●
Single-lever joystick with F/R+KD+horn+3rd function valve roller	●
Secondary steering	●
Dual brake pedals	●
3rd function valve	●
Hydraulic quick coupler lines+button	●
Ride control system(Boom suspension system)	●
Boom kick-out	●
Bucket self-leveling and return to dig	●

WORK TOOLS

Bucket volume 2.3m³(Cutting edge, bolt-on)	●
Quick coupler	●

CABIN

Cab with ROPS / FOPS certification	●
Steering wheel with turning signal control lever	●
Emergency hammer	●
Rear window, heated	●
Rear mirrors, outside (2, foldable, heated), inside(1)	●
Sun visor, front window	●
Air-Suspension seat (cloth, heated)	●
Seat belt, 2-point retractable	●
Armrest adjustable in multiple directions	●
Rear-view camera	●
360° view camera	●
7 inch smart color display	●
Auto air conditioner	●

ELECTRICITY

Battery main switch	●
12-volt socket	●
Cigarette lighter, 24V	●
USB socket	●
Bluetooth radio	●
Back up alarm	●
Travel acoustic alarm	●
Travel strobe light alarm	●

Standard and optional equipment may vary. Consult your local dealer for details

SANY



QUALITY CHANGES THE WORLD

SANY ITALIA S.R.L.

VIA DRUENTO 254/B VENARIA REALE (TO) - ITALY

TEL. 0118002130

[HTTPS://WWW.SANYITALIA.COM](https://www.sanyitalia.com)

October 2022 Edition

Materials and specifications are subject to change without notice. Featured machines in photos may include additional equipment. See your local dealer for available options please.